

## Bénéteau Oceanis 45

129.000 €

### Description

The Bénéteau Oceanis 45 is an ocean cruiser, which offers great comfort together with very good sailing performance. Twin wheel steering, a very spacious cockpit, open deck, immense interiors, a good level of equipment and a good general condition are some of the features that will attract your attention. 4 cabins, 2 toilets, 55 HP Diesel engine, furling sails, Radar bow with mainsail, folding stern gate and platform (2,85 m x 0,70 m) are some of the features that will catch your attention.



The Bénéteau Oceanis 45 is moored in Palma de Mallorca and is available for your visit.

This boat comes from a charter fleet and is professionally maintained and repaired. Ready to sail! The price includes VAT (which can be deducted depending on the tax situation of the buyer).

### General Information

Year:	2012	Engine:	Yanmar
Length:	13,94	Power:	55
Flag:	Spanish	Reference:	MB20461
Material:	GRP	Location:	Mallorca

### Dimensions

LOA:	13,94	Waterline Length:	12,98
Beam:	4,50	Displacement:	10549
Draft:	1,75	Hull Length:	13,50

### Distribution

Cabins:	4	Salon	
Kitchen		Bathrooms:	2

Berths: 10

Chart Table

Salon Berths

## Engine - Plumbing - Electricity

Engine Model: 4JH5CE

Fuel Type: Diesel

Power per Engine: 55

Diesel Capacity: 200

Number of Showers: 2

Engine Type: Z-Drive

Number of Engines: 1

Number of Cylinders: 4

Water Capacity: 370

Number of Batteries: 3

## Equipment Engine

- Z drive
- Holding tank
- Heater
- Manual bilge pump
- Boiler
- Battery charger

- Twin wheels
- Electric pressurized water system
- Deck shower
- Electric bilge pump
- Shore power
- Solar panels

## Electronics

- Compass
- Speed/Log
- VHF radio with DSC
- Radio beacon EPIRB

- Echo sounder
- Wind
- Autopilot

## Rigging - Sails

- Boom vang
- Furling Genoa
- Number of Masts: 1

- Furling Main
- Self-tailing winches
- Spreader Lines: 2

## Various Equipment

- Bow thrusters
- Out board engine
- Electric windlass
- Music, sound systems
- Spray hood
- Bathing platform
- Oven
- Electric Fridge

- Dinghy
- Life raft
- Anchor with chain
- Bimini
- Marine WC
- Gas stove
- Twin sink

## Photos

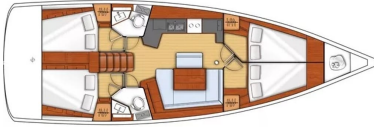



*All data reflected in this sheet is offered with the best intentions, however, we will not be responsible for possible errors reflected in the text and we recommend an on-board inspection for verification. This document is not contractual.*